

E14 one-piece thermoplastic lampholder and accessories

Rated current: 2A

Rated voltage: 250V

Rated temperature: T180 - T210

Overvoltage category: II

Material: thermoplastic

Other colours on request

Approval: 

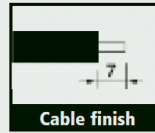

E14 one-piece lampholder

Terminals: spring type for rigid or flexible cables 0.5÷1.5 mm²

Outer shell: plain

Connection: through holes for Ø3 mm self-threading screws or with snap-on domes

Packaging: 1000 pieces

T180 code **023978 black** code **023977 white**

T210 code **023981 black** code **023980 white**

code **023982 gold**

50S/T180/BI/M/PDE/E14



Dome for E14 one-piece lampholder

Connection: threaded entry (M10x1) with retainer

Locking device notch: external

Packaging: 1000 pieces

h 15 mm*code **021074 black** code **021073 white**
code **021075 gold**

CAPPELLO E14 ART. 105 ASF SL BI

h 15 mm code **030931 black** code **026093 white**
code **011883 gold**

CAPPELLO E14 ART. 105 ASF BI

h 21 mm*code **025546 black** code **025545 white**

CAPPELLO E14 ART. 105 H21 ASF SL BI

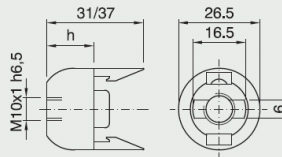

*Suitable for side exit of cable.